

NEEL VOL FIRE DEPT DANVILLE, AL

S.O.145554 / 0111238

PUMPER SPARTAN FC-94 4X2 CHASSIS

1500 GPM HALE QMAX PUMP 780 GALLON WATER TANK		HOSE LOAD: NFPA CAPACITY	
COMPT.	OPENING	INTERIOR DIMENSION	
L1	42W 68H	42W 12H 12D UPPER	42W 56H 26D LOWER
R1	42W 68H	42W 34H 12D UPPER	42W 30H 26D LOWER
L2	56W 34H	56W 12H 12D UPPER	56W 22H 26D LOWER
R2	56W 34H	56W 34H 12D	
L3	56W 68H	42W 12H 12D FRONT UPPER	42W 56H 26D FRONT LOWER
		14W 12H 10D REAR UPPER	14W 56H 24D REAR LOWER
		42W 34H 12D FRONT UPPER	42W 30H 26D FRONT LOWER
R3	56W 68H	14W 34H 10D REAR UPPER	14W 30H 24D REAR LOWER
B1	38W 47H	38W 63H 26D	

THIS DRAWING IS FOR REFERENCE PURPOSES. ALL DIMENSIONS ARE SUBJECT TO MINOR VARIATIONS DUE TO MANUFACTURING PROCESSES.

This print is the property of E-One, Inc. and is loaned to you subject to return on demand, unless otherwise agreed to in writing by E-One, Inc. Its contents are confidential and must not be copied or submitted to third parties for use or examination.

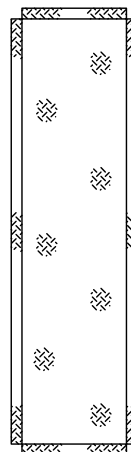

HOSEBED HEIGHT:
(FOR REFERENCE ONLY)
TO TAILBOARD: 68"
TO GROUND: 92±2"

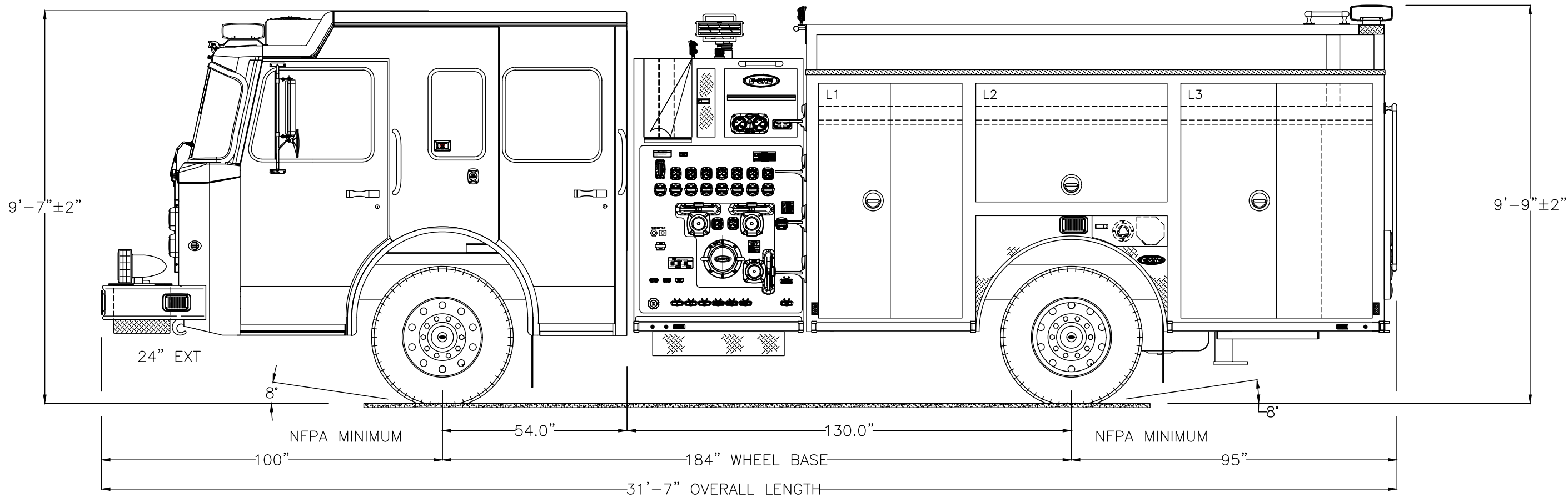
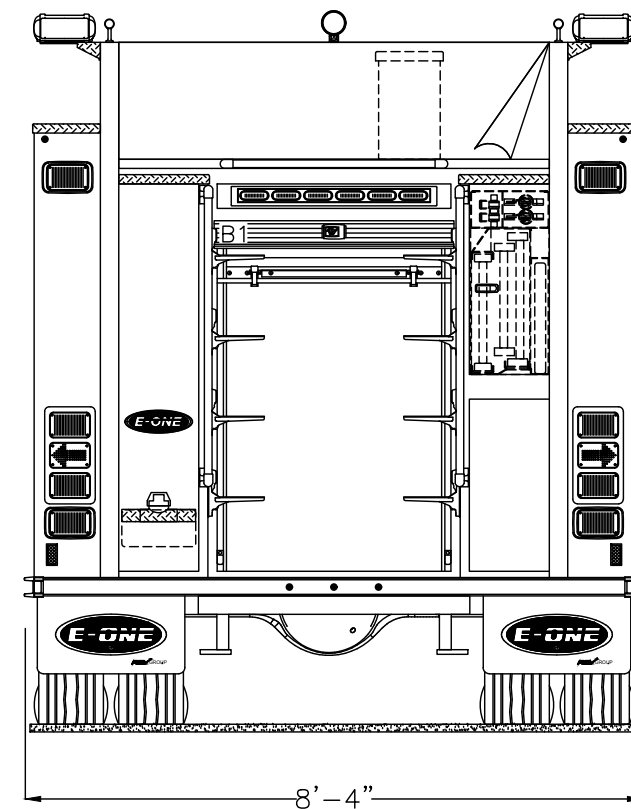

DADKINS	A5	ACTION ITEMS	2022-MAR-07	DGALLAGHER
DRAWN BY	REV	DESCRIPTION	DATE	APPROVED
APPROVAL REVISIONS				SHEET 1 OF 2

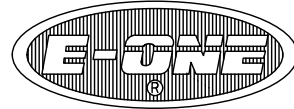

NEEL VOL FIRE DEPT
DANVILLE, AL
S.O. 145554 / Q111238
PUMPER
SPARTAN FC-94 4X2 CHASSIS

THIS DRAWING IS FOR REFERENCE PURPOSES. ALL DIMENSIONS ARE
 SUBJECT TO MINOR VARIATIONS DUE TO MANUFACTURING PROCESSES.

This print is the property of E-ONE, Inc. and is loaned to you
 subject to return on demand, unless otherwise agreed to in writing by
 E-ONE, Inc. Its contents are confidential and must not be
 copied or submitted to third parties for use or examination.

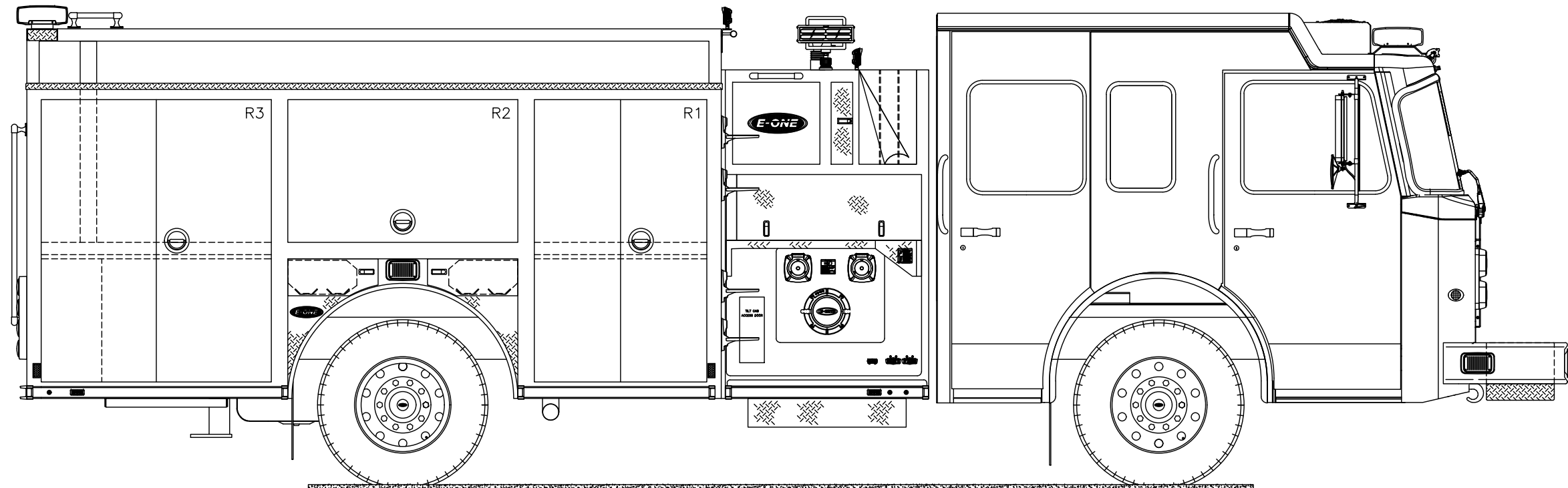
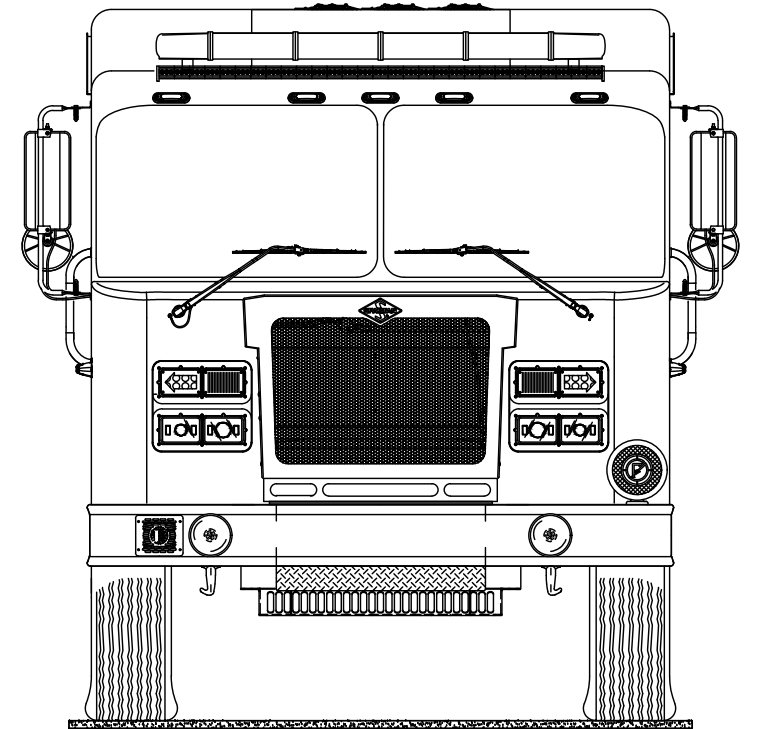

DADKINS	A5	ACTION ITEMS	2022-MAR-07	DGALLAGHER
DRAWN BY	REV	DESCRIPTION	DATE	APPROVED
APPROVAL REVISIONS				SHEET 2 OF 2