

CANANDAIGUA CITY FIRE DEPT. CANANDAIGUA, NY

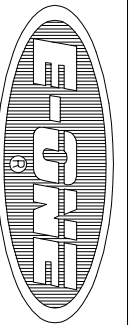

S.O. 144537 / QUOTE 103236
AERIAL BODY W/SIDESTACKER HOSEBED
E-ONE CYCLONE CHASSIS
HP100 PLATFORM

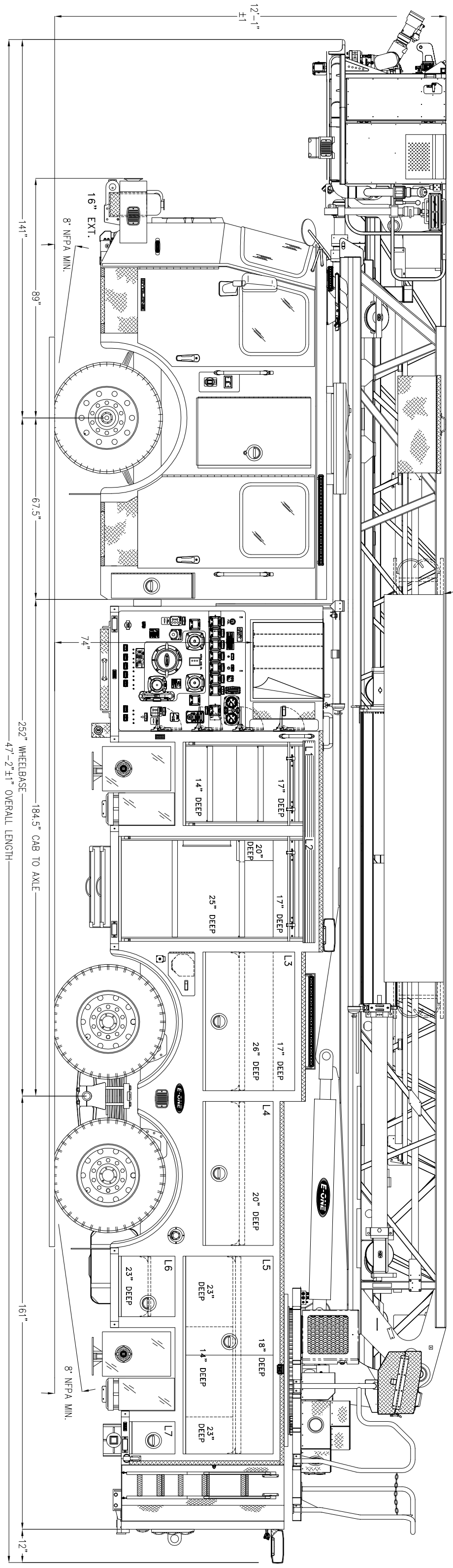
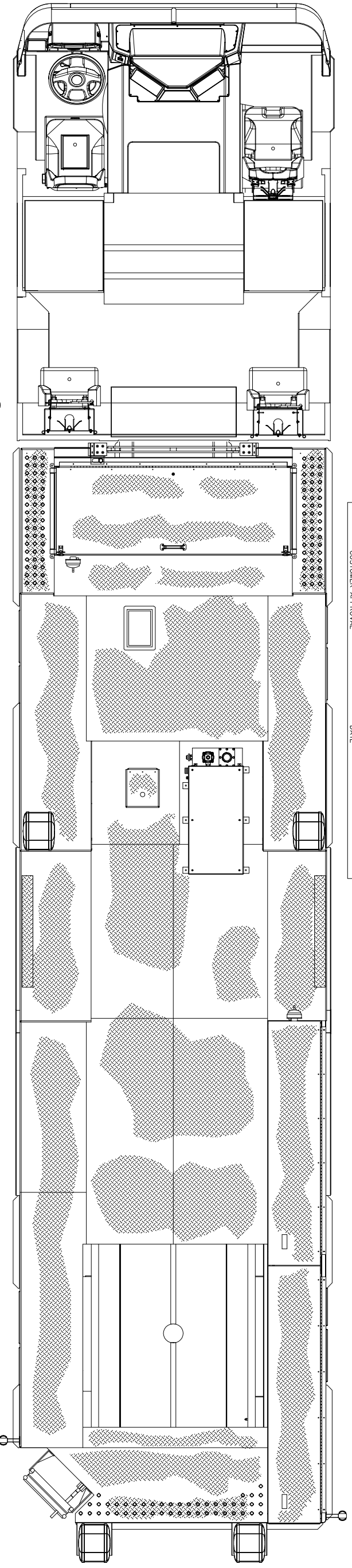

THIS DRAWING IS FOR REFERENCE PURPOSES. ALL DIMENSIONS ARE SUBJECT TO MINOR VARIATIONS DUE TO MANUFACTURING PROCESSES.
(FOR INTERNAL SALES PURPOSES ONLY)

DEALER APPROVAL _____ DATE _____ AS IS

CUSTOMER APPROVAL _____ DATE _____ WITH REVISIONS

DATE	DESCRIPTION	APPROVED
2023-MAY-09	REV 1	GABRIEL
	REV 2	GABRIEL
	REV 3	GABRIEL
	REV 4	GABRIEL
	REV 5	GABRIEL
	REV 6	GABRIEL
	REV 7	GABRIEL
	REV 8	GABRIEL
	REV 9	GABRIEL
	REV 10	GABRIEL

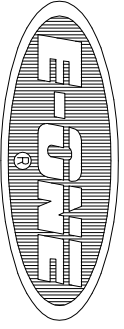

CANANDAIGUA CITY FIRE DEPT. CANANDAIGUA, NY

S.O. 144537 / QUOTE 103236
AERIAL BODY W/SIDESTACKER HOSEBED
E-ONE CYCLONE CHASSIS
HP100 PLATFORM

THIS DRAWING IS FOR REFERENCE PURPOSES. ALL DIMENSIONS ARE
SUBJECT TO MINOR VARIATIONS DUE TO MANUFACTURING PROCESSES.
(FOR INTERNAL SALES PURPOSES ONLY)
DEALER APPROVAL _____ DATE _____ AS IS
CUSTOMER APPROVAL _____ DATE _____ WITH REVISIONS

1500 GPM HALE OMAX PUMP		HOSE LOAD: 750' OF 4.00" LDH	
COMP.	OPENING	INTERIOR DIMENSION	
L1/R1	29W	38H	31W 19H NOTED UPPER
L2/R2	37W	62H	31W 19H NOTED LOWER
L3	51W	33H	39W 19H NOTED UPPER
R3	51W	26H	43H NOTED LOWER
R4	22W	34H	51W 8H 17D UPPER
L4	53W	25H	51W 8H 17D LOWER
R5	31W	10H	51W 25H 26D LOWER
L5	73W	32H	73W 15H 18D UPPER
R6	36W	30H	73W 17H NOTED LOWER
L6	22W	20H	36W 30H 23D
L7	12W	16H	22W 20H 23D
GROUND LADDERS			
ITEM	LADDER LENGTH	MODEL NUMBER	QTY
A	35' 2-SECT.	PEL-35	2
B	28' 2-SECT.	PEL-28	1
C	24' 2-SECT.	PEL-24	1
D	20' ROOF	DRL-20	1
E	16' ROOF	DRL-16	1
F	14' ROOF	DRL-14	1
G	12' ROOF	DRL-12	1
H	10' ATTIC	FL-10	1
I	8' ATTIC	FL-8	1

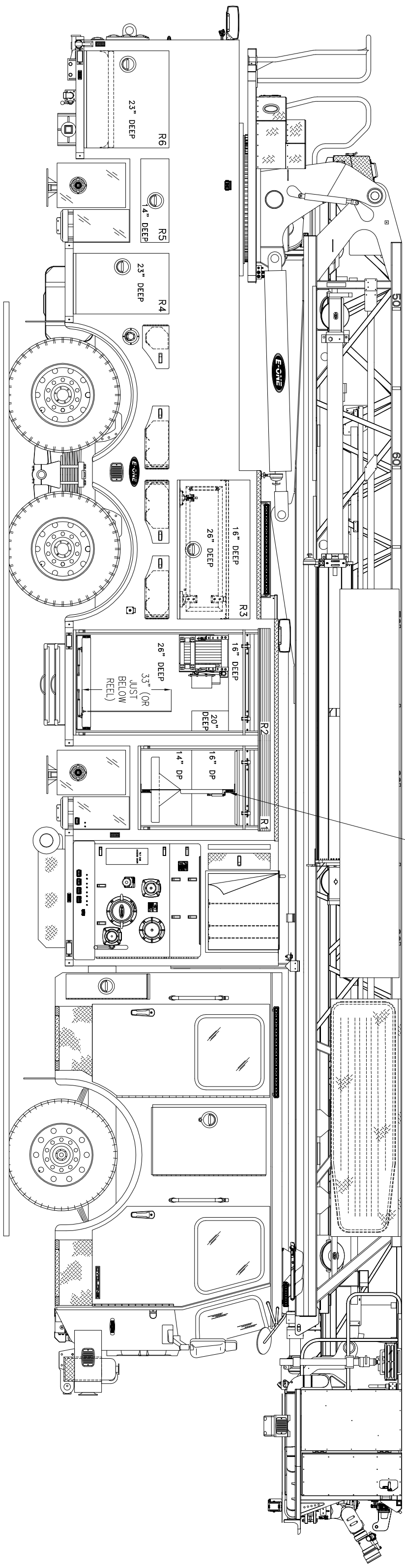
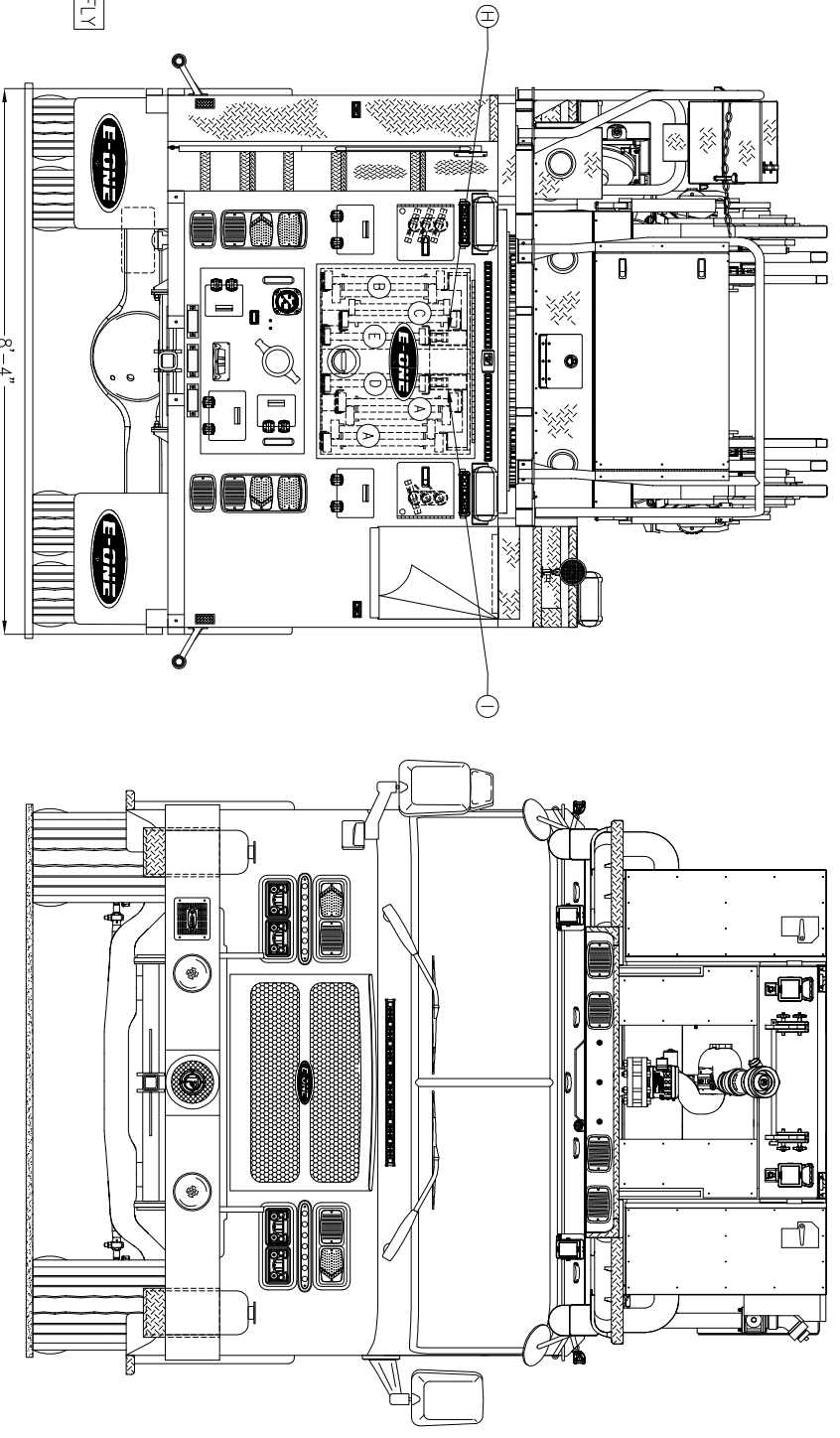

TO BE MOUNTED AT FINAL INSPEC.

DATE	BY	DESCRIPTION	DATE	APPROVED
2023-05-10	GABET	2023-05-10	GABET	
	REV			
	APPROVAL	REVISIONS		